

Series RV CHECK VALVES FOR ALL FLUORINATED REFRIGERANTS

PRODUCT DATA

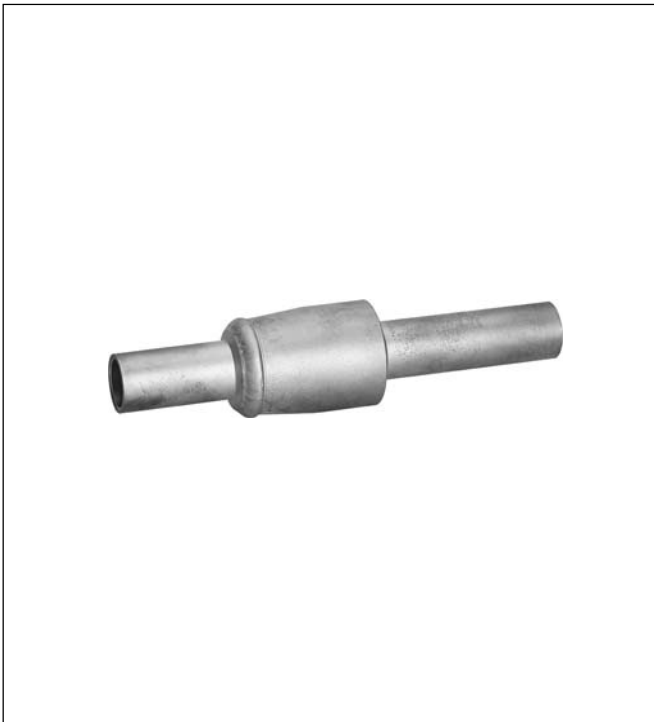

Features

- **RV:** with standard spring
- **RVS:** with strengthened spring
- Hermetically welded type
- Low pressure drop
- Copper plated solder connections
- Refrigerants: all CFC, HCFC, HFC, not for ammonia

Specification

Nominal capacity range	see table on page 2
Maximum pressure PS	31.5 bar 10 bar at $t < -20\text{ }^{\circ}\text{C}$
Maximum temperature	120 °C
Minimum temperature	-40 °C

Application

Check valves series RV are installed in the liquid line, hot gas line or suction line of a refrigerated plant to permit the flow of the refrigerant only in one direction. This is realised by a spring-loaded piston which opens the valve only in one direction.

Series RVS with strengthened spring is developed especially for installation in the high pressure line of compound pack units.

Materials

Housing, piston	brass
Sealing material	Teflon
Connection tubes	copper plated brass

Capacities

Type	ΔP^* (bar)	kv- value (m ³ /h)	Q _N (kW)											
			Liquid line				Suction gas line				Hot gas line			
			R22	R134a	R404A R507	R410A	R22	R134a	R404A R507	R410A	R22	R134a	R404A R507	R410A
RV-02 MMS RV-02 S	0.06	0.37	6.7	6.2	4.4	6.2	1.0	0.8	0.8	1.0	4.4	3.2	3.7	4.7
RV-03 MMS RV-03 S	0.06	1.75	31.7	29.3	20.8	29.2	4.7	3.8	3.8	4.5	20.8	15.1	17.5	22.2
RV-04 MMS RV-04 S	0.05	3.27	59.2	54.8	38.9	54.6	8.8	7.1	7.1	8.4	38.0	28.3	32.7	40.6
RV-05 S	0.05	3.64	65.9	61.0	43.3	60.7	9.8	7.9	7.9	9.3	43.3	31.5	36.4	46.3
RV-07 S	0.03	7.50	136.4	126.4	89.5	125.7	20.5	16.3	17.0	19.5	87.5	63.8	75.0	93.5
RVS-02 MMS RVS-02 S	0.30	0.31	5.6	5.2	3.7	5.2	-	-	-	-	3.7	2.7	3.1	4.0
RVS-03 MMS RVS-03 S		1.57	28.4	26.3	18.7	26.2	-	-	-	-	18.7	13.6	15.7	20.0
RVS-04 MMS RVS-04 S		2.66	48.2	44.6	31.6	44.4	-	-	-	-	31.6	23.0	26.6	33.8
RVS-05 S		2.90	52.5	48.6	34.5	48.4	-	-	-	-	34.5	25.1	29.0	36.9
RVS-07 S		6.90	125.5	116.3	82.6	115.7	-	-	-	-	80.5	58.7	69.0	86.0

* ΔP = min. pressure drop at which the valve is completely open

The nominal capacity Q_N as mentioned in table above refers to the following conditions:

Liquid and suction gas:

evaporating temperature to: +4 °C
 condensing temperature to: +38 °C
 pressure drop: 0.15 bar

Hot gas:

temperature of hot gas: +85 °C
 pressure drop: 1.0 bar

Dimensions and Weights

Type	Connection (A)	Dimensions (mm)				Weight (kg)
		B	C	D	L	
RV-02 MMS	6 mm ODF	42	22	18	95	approx. 0.05
RV-02 S	1/4" ODF	42	22	18	95	
RV-03 MMS	10 mm ODF	42	22	18	95	approx. 0.05
RV-03 S	3/8" ODF	42	22	18	95	
RV-04 MMS	12 mm ODF	48	28	27	117	approx. 0.15
RV-04 S	1/2" ODF	48	28	27	117	
RV-05 S	16 mm ODF 5/8" ODF	48	28	27	117	approx. 0.20
RV-07 S	22 mm ODF 7/8" ODF	72	72	35.5	186	approx. 0.25
RVS-02 MMS	6 mm ODF	42	22	18	95	approx. 0.05
RVS-02 S	1/4" ODF	42	22	18	95	
RVS-03 MMS	10 mm ODF	42	22	18	95	approx. 0.05
RVS-03 S	3/8" ODF	42	22	18	95	
RVS-04 MMS	12 mm ODF	48	28	27	117	approx. 0.15
RVS-04 S	1/2" ODF	48	28	27	117	
RVS-05 S	16 mm ODF 5/8" ODF	48	28	27	117	approx. 0.20
RVS-07 S	22 mm ODF 7/8" ODF	72	72	35.5	186	approx. 0.25

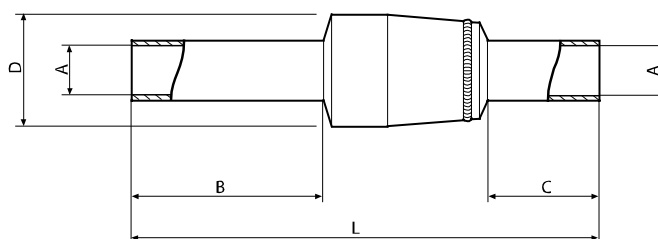

Honeywell

Automation and Control Solutions

Honeywell GmbH
Hardhofweg
74821 Mosbach/Germany
Phone: +49 (0) 62 61 / 81-475
Fax: +49 (0) 62 61 / 81-461
E-Mail: cooling.mosbach@honeywell.com
www.honeywell-cooling.com

Manufactured for and on behalf of the
Environment and Combustion Controls
Division of Honeywell Technologies Sàrl,
Ecublens, Route du Bois 37, Switzerland
by its authorised representative Honeywell GmbH